

Instructions

Bellevue AJ7 Arne Jacobsen 1929



Congratulations on your new Bellevue lamp designed in 1929 by Arne Jacobsen. We hope you will enjoy using this product and follow these instructions to ensure correct installation. If you have any questions or comments, please do not hesitate to contact us by mail at: info@andtradition.com

&Tradition®

Bellevue AJ7

Arne Jacobsen

1929

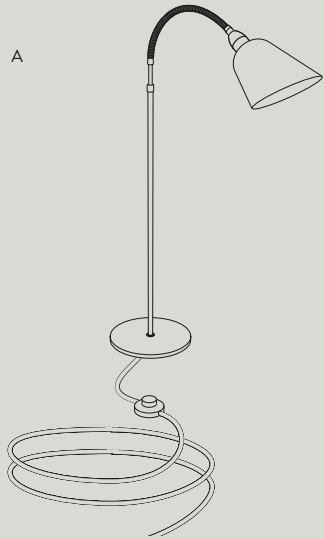

Please read these instructions carefully and retain them for future reference to ensure that the product is used correctly. For your own safety, please study each step of this instruction manual first. &Tradition is not responsible for any faults or damages caused by not following these instructions correctly. Do not modify this product in any way.

Content

A Lamp

Tools needed

- Bulb type E27

Safety precautions

- Dispose of plastic bag from packaging and do not allow children to play with it.
- The lamp is only intended for interior use.
- Lamp shade gets hot after prolonged use.
- Do not place the cable in reach of small children or any where there is a risk of falling over it.
- If the external cable or cord of this lamp is damaged, it must be replaced by the manufacture or a similar qualified person in order to avoid a hazard.

Cleaning instructions

- The Bellevue lamp is made from solid brass and lacquered aluminum. The brass used is uncoated and will therefore develop a unique and beautiful patina over time.
- Wipe surface of lamp shade with a soft, damp sponge or cloth, and wipe immediately after with a dry cloth.
- Do not use any abrasive cleaning tools such as steel wool, scouring sponges or stiff brushes.
- Never use strong cleaning agents such as white spirit, terpentine household glass cleaner or cellulose thinners.
- Only wipe the inside of the shade with a soft, damp cloth or feather duster.

For indoor use only
E27 maximum 25W
Bulb not included

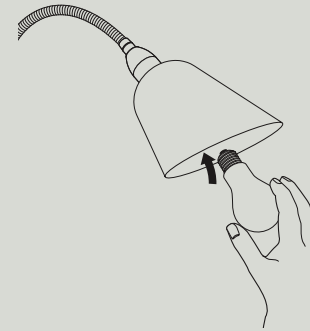

Step 1

The lamp is delivered fully assembled. Instal the light bulb.

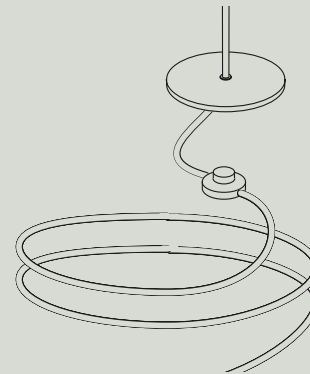

Step 2

Insert the plug into a wall socket and use the switch on the cord to turn the lamp on and off.

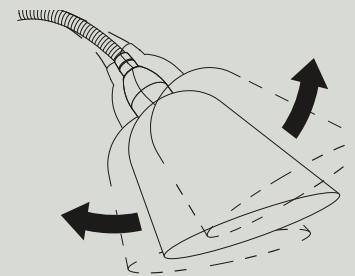

Step 3

Use the flexible swan-neck to set the shade at a desired angle. It is best to set the angle before turning the lamp on as the shade gets hot when the lamp is in use for longer periods of time.



